

WETX

Bulkhead Union Elbow
37° Flare / 37° Flare

SAE 070701
HPD Base # 2353
WETX-WLN – Body with locknut
(See page B10 for WLN)

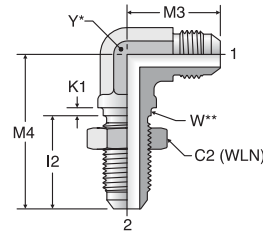

Y* – Across wrench flats.
W** – Bulkhead pilot dia.
recommended clearance hole
+.015 over W dia.

TUBE FITTING PART #	END SIZE		C2 HEX (in.)	I2 (in.)	K1 (in.)	M3 (in.)	M4 (in.)	W DIA (in.)	MAX BULKHEAD WALL THICKNESS (in.)	Y (in.)	Dynamic Pressure (x 1,000 PSI)		
	1 & 2 (in.)										-S	-SS	-B
3 WETX	3/16		5/8	0.92	0.09	0.94	1.50	0.38	0.25	7/16	7.5	7.7	3.3
4 WETX	1/4		11/16	1.20	0.09	0.97	1.59	0.44	0.25	7/16	7.5	7.7	3.3
5 WETX	5/16		3/4	1.02	0.09	1.06	1.72	0.50	0.25	9/16	6.0	6.0	3.3
6 WETX	3/8		13/16	1.09	0.09	1.09	1.81	0.56	0.35	9/16	6.0	6.0	3.3
8 WETX	1/2		1	1.25	0.13	1.36	2.11	0.75	0.35	3/4	6.0	6.0	3.3
10 WETX	5/8		1 1/8	1.39	0.13	1.56	2.39	0.88	0.35	7/8	5.0	5.0	3.3
12 WETX	3/4		1 3/8	1.56	0.13	1.78	2.67	1.06	0.35	1 1/16	5.0	5.0	3.3
14 WETX	7/8		1 1/2	1.56	0.13	1.92	2.80	1.19	0.35	1 5/8	5.0	5.0	3.3
16 WETX	1		1 5/8	1.56	0.13	1.94	2.80	1.31	0.35	1 5/8	4.0	3.5	2.3
20 WETX	1 1/4		1 7/8	1.61	0.13	2.17	3.13	1.63	0.35	1 5/8	4.0	3.0	2.0

C6X

Swivel Nut Elbow
37° Flare / 37° Swivel

SAE 070221
HPD Base # 3903

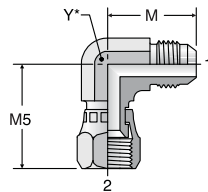

Y* – Across wrench flats

TUBE FITTING PART #	END SIZE		M (in.)	M5 (in.)	Y (in.)	Dynamic Pressure (x 1,000 PSI)			
	1 (in.)	2 (in.)				-S	-SS	-B	D
3 C6X	3/16	3/16	0.83	1.00	7/16	7.5	7.7	3.3	3.8
4 C6X	1/4	1/4	0.89	1.00	7/16	7.5	7.7	3.3	3.8
5 C6X	5/16	5/16	0.95	1.06	9/16	6.0	6.0	3.3	3.0
6 C6X	3/8	3/8	1.06	1.25	9/16	6.0	6.0	3.3	3.0
8 C6X	1/2	1/2	1.25	1.38	3/4	6.0	6.0	3.3	3.0
10 C6X	5/8	5/8	1.45	1.62	7/8	5.0	5.0	3.3	2.5
12 C6X	3/4	3/4	1.66	1.75	1 1/16	5.0	5.0	3.3	2.5
12-24 C6X	3/4	1 1/2	2.11	2.59	1 7/8	3.0	2.5	2.0	•
14 C6X	7/8	7/8	1.81	1.78	1 5/16	5.0	5.0	3.3	2.5
16 C6X	1	1	1.81	2.00	1 5/16	4.0	3.0	2.6	2.0
16-12 C6X	1	3/4	1.81	1.87	1 5/16	4.0	3.0	2.6	2.0
20 C6X	1 1/4	1 1/4	2.06	2.31	1 5/8	4.0	3.0	2.6	•
24 C6X	1 1/2	1 1/2	2.33	2.59	1 7/8	3.0	2.5	2.0	•
32 C6X	2	2	3.06	3.51	2 1/2	2.0	1.5	1.3	•

AOEX6

Swivel Elbow Straight
Thread Connector
SAE-ORB / 37° Swivel

HPD Base # 2506

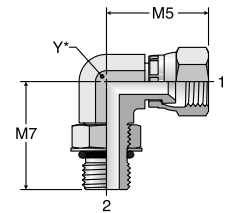

Y* – Across wrench flats

TUBE FITTING PART #	END SIZE		M5 (in.)	M7 (in.)	Y (in.)	Dynamic Pressure (x 1,000 PSI)		
	1 (in.)	2 UN/UNF-2A				-S	-SS	-B
4 AOEX6	1/4	7/16 - 20	1.00	1.03	7/16	6.0	6.0	3.3
6 AOEX6	3/8	9/16 - 18	1.25	1.25	9/16	6.0	6.0	3.3
8 AOEX6	1/2	3/4 - 16	1.38	1.45	3/4	6.0	6.0	3.3
10 AOEX6	5/8	7/8 - 14	1.62	1.70	7/8	5.0	5.0	3.3
12 AOEX6	3/4	1 1/16 - 12	1.75	1.94	1 1/16	5.0	5.0	3.3
16 AOEX6	1	1 5/16 - 12	2.00	2.05	1 5/16	4.0	3.0	2.6

Dimensions and pressures for reference onl , sub ect to change.